

0106 Reflecting Mirror

FM2000-S



1550 nm Fiber Sensors Fiber Mirror, SM

The FM2000-S has very low insertion loss, high return loss and high stability & reliability. It can be used for fiber lasers, fiber sensor, fiber optic instruments, research and coherent detecting.

FEATURES

- High Return Loss
- Low Insertion Loss
- High Stability & Reliability

USE IN

- Fiber Optic Instruments
- Coherent Detecting
- Fiber Sensor
- Fiber Lasers
- Research

MECHANICAL DRAWING

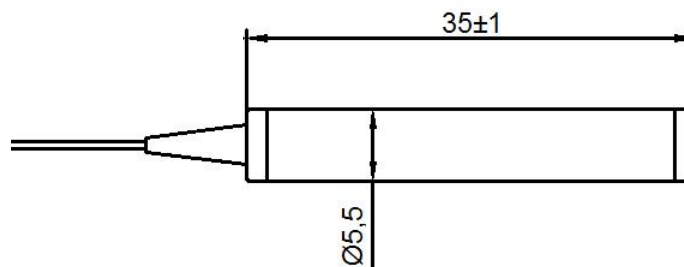

Center Wavelength	1550±30 nm
Reflectivity	95% min.
Insertion Loss	1 dB max.
Polarization Dependent Loss	0.1 dB max.
Polarization Mode Dispersion	0.1 ps max.
Return Loss	45 dB min.
Power Handling	300 mW min.
Fiber Type	SMF 28e
Operating Temperature	+5°C to +70°C
Storage Temperature	-40°C to +85°C
Dimension	35x5.5x5.5 mm

Order notes to our customers: The default parameters are as follows. For special needs, please contact sales.

1) Connector FC/APC, 900 um, 1 m by default for all devices except for high power devices.

2) Slow axis working, fast axis blocked, connector key is aligned to slow axis by default for PM devices.